

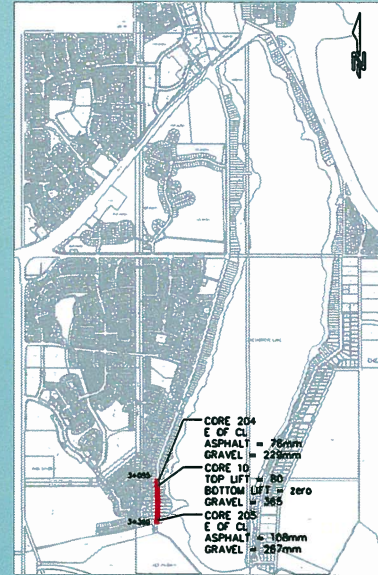

PROPOSED EAST AND WEST CHESTERMERE DRIVE RE-DEVELOPMENT SEGMENT W6

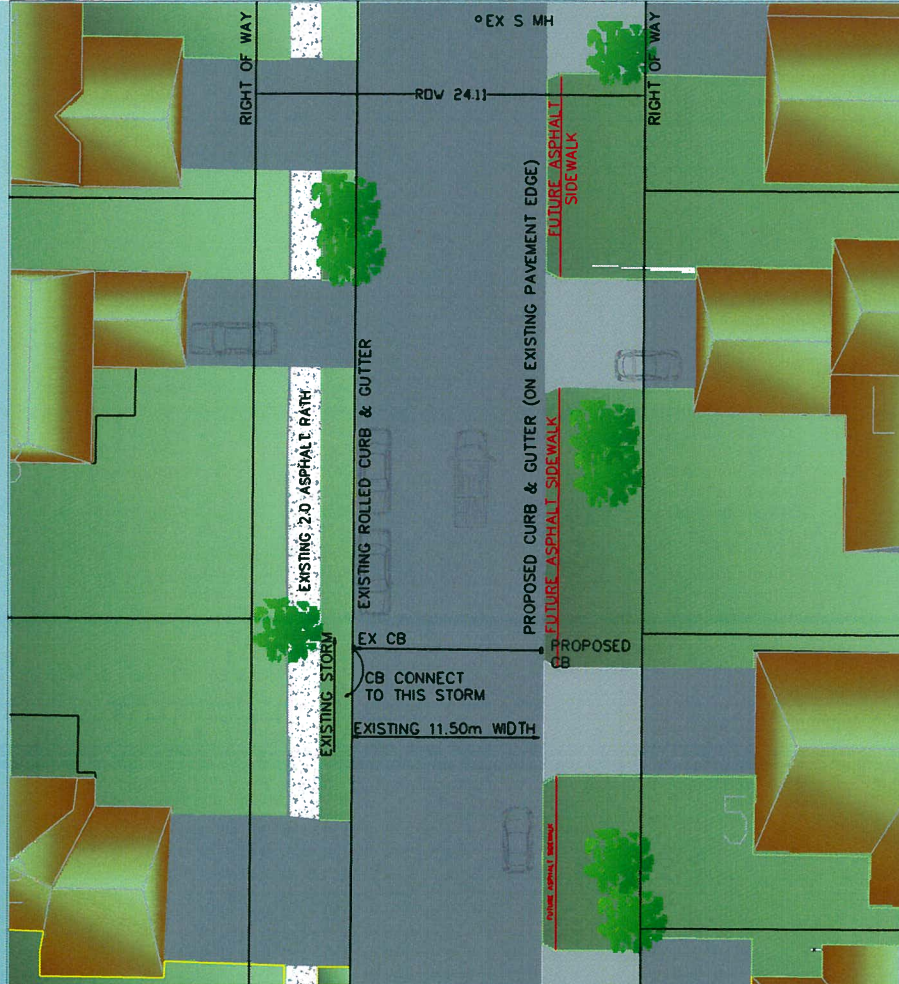

KEY PLAN

LANDSCAPING BETWEEN PROPERTY LINE AND EITHER EDGE OF PAVEMENT, CURB AND GUTTER, OR BACK OF SIDEWALK TO BE FURNISHED BY TOWN OF CHESTERMERE

PLAN

- 1.0 EXISTING ASPHALT AND GRAVEL THICKNESSES DO NOT SATISFY MINIMUM REQUIREMENTS SPECIFIED BY CITY OF CALGARY FOR COLLECTOR STANDARD, HOWEVER REQUIREMENT FOR COLLECTOR STANDARD DEFERRED UNTIL WEST CHESTERMERE DRIVE EXTENDED SOUTH ACROSS THE CANAL.

TRAFFIC VOLUMES SUGGEST THIS IMPROVEMENT MAY BE DEFERRED INDEFINITELY.

- 2.0 PROPOSED ROLLED CURB, GUTTER ON EAST SIDE WITH PROVISION FOR FUTURE ASPHALT SIDEWALK.
- 3.0 INSTALL CATCH-BASINS ON NEW EAST CURB AND GUTTER TO STOP OVERLAND FLOW WITHIN RIGHT-OF-WAY TO LOTS ON EAST SIDE OF EAST CHESTERMERE DRIVE.
- 4.0 PROPOSED ROAD TO HAVING PARKING LANE ON BOTH SIDES, IDENTICAL TO MARINA DRIVE. PARKED CARS WILL PROVIDE MEASURE OF TRAFFIC CALMING.

NOTES

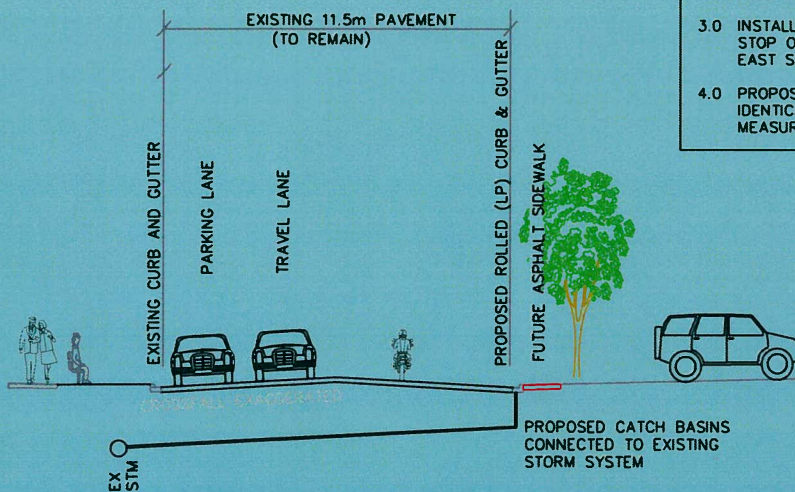

SECTION



Suite 300, 6807 Railway Street SE
Calgary, Alberta T2H 2V6
Tel: (403) 246-4500 Fax: (403) 246-4220